



Hammersmith and Fulham
Application to vary a premises licence
Licensing Act 2003

For help contact
licensing@lbhf.gov.uk
 Telephone: 020 8753 1081

* required information

Section 1 of 18

You can save the form at any time and resume it later. You do not need to be logged in when you resume.

System reference This is the unique reference for this application generated by the system.

Your reference You can put what you want here to help you track applications if you make lots of them. It is passed to the authority.

Are you an agent acting on behalf of the applicant?

- Yes No

Put "no" if you are applying on your own behalf or on behalf of a business you own or work for.

Applicant Details

* First name

* Family name

* E-mail

Main telephone number Include country code.

Other telephone number

Indicate here if the applicant would prefer not to be contacted by telephone

Is the applicant:

- Applying as a business or organisation, including as a sole trader
 Applying as an individual

A sole trader is a business owned by one person without any special legal structure. Applying as an individual means the applicant is applying so the applicant can be employed, or for some other personal reason, such as following a hobby.

Continued from previous page...

Address

* Building number or name	Chicken Cottage - 82
* Street	North End Road
District	
* City or town	London
County or administrative area	
* Postcode	W149ES
* Country	United Kingdom

Agent Details

* First name	Tom
* Family name	Corcoran
* E-mail	
Main telephone number	
Other telephone number	

Include country code.

Indicate here if you would prefer not to be contacted by telephone

Are you:

- An agent that is a business or organisation, including a sole trader
- A private individual acting as an agent

A sole trader is a business owned by one person without any special legal structure.

Your Address

Address official correspondence should be sent to.

* Building number or name	Chicken Cottage - 14
* Street	Beddington Farm Road
District	
* City or town	Croydon
County or administrative area	
* Postcode	CR04WP
* Country	United Kingdom

Section 2 of 18

APPLICATION DETAILS

Continued from previous page...

This application cannot be used to vary the licence so as to extend the period for which the licence has effect or to vary substantially the premises to which it relates. If you wish to make that type of change to the premises licence, you should make a new premises licence application under section 17 of the Licensing Act 2003.

I/we, as named in section 1, being the premises licence holder, apply to vary a premises licence under section 34 of the Licensing Act 2003 for the premises described in section 2 below.

* Premises Licence Number

Are you able to provide a postal address, OS map reference or description of the premises?

Address OS map reference Description

Postal Address Of Premises

Building number or name

Street

District

City or town

County or administrative area

Postcode

Country

Premises Contact Details

Telephone number

Non-domestic rateable value of premises (£)

Section 3 of 18

VARIATION

Do you want the proposed variation to have effect as soon as possible? Yes No

Do you want the proposed variation to have effect in relation to the introduction of the late night levy? Yes No

You do not have to pay a fee if the only purpose of the variation for which you are applying is to avoid becoming liable to the late night levy.

If your proposed variation would mean that 5,000 or more people are expected to attend the premises at any one time, state the number expected to attend

Describe Briefly The Nature Of The Proposed Variation

Continued from previous page...

Describe the premises. For example the type of premises, its general situation and layout and any other information which could be relevant to the licensing objectives. Where your application includes off-supplies of alcohol and you intend to provide a place for consumption of these off-supplies, you must include a description of where the place will be and its proximity to the premises.

Fast food restaurant and takeaway. Licensable area is on the ground floor with a basement for Storage.

Section 4 of 18

PROVISION OF PLAYS

[See guidance on regulated entertainment](#)

Will the schedule to provide plays be subject to change if this application to vary is successful?

- Yes No

Section 5 of 18

PROVISION OF FILMS

[See guidance on regulated entertainment](#)

Will the schedule to provide films be subject to change if this application to vary is successful?

- Yes No

Section 6 of 18

PROVISION OF INDOOR SPORTING EVENTS

[See guidance on regulated entertainment](#)

Will the schedule to provide indoor sporting events be subject to change if this application to vary is successful?

- Yes No

Section 7 of 18

PROVISION OF BOXING OR WRESTLING ENTERTAINMENTS

[See guidance on regulated entertainment](#)

Will the schedule to provide boxing or wrestling entertainments be subject to change if this application to vary is successful?

- Yes No

Section 8 of 18

PROVISION OF LIVE MUSIC

[See guidance on regulated entertainment](#)

Will the schedule to provide live music be subject to change if this application to vary is successful?

- Yes No

Section 9 of 18

PROVISION OF RECORDED MUSIC

Continued from previous page...

[See guidance on regulated entertainment](#)

Will the schedule to provide recorded music be subject to change if this application to vary is successful?

- Yes
- No

Section 10 of 18

PROVISION OF PERFORMANCES OF DANCE

[See guidance on regulated entertainment](#)

Will the schedule to provide performances of dance be subject to change if this application to vary is successful?

- Yes
- No

Section 11 of 18

PROVISION OF ANYTHING OF A SIMILAR DESCRIPTION TO LIVE MUSIC, RECORDED MUSIC OR PERFORMANCES OF DANCE

[See guidance on regulated entertainment](#)

Will the schedule to provide anything similar to live music, recorded music or performances of dance be subject to change if this application to vary is successful?

- Yes
- No

Section 12 of 18

PROVISION OF LATE NIGHT REFRESHMENT

Will the schedule to provide late night refreshment be subject to change if this application to vary is successful?

- Yes
- No

Standard Days And Timings

MONDAY

Start

End

Start

End

Provide timings in 24 hour clock (e.g., 16:00) and only give details for the days of the week when you intend the premises to be used for the activity.

TUESDAY

Start

End

Start

End

WEDNESDAY

Start

End

Start

End

THURSDAY

Start

End

Start

End

Continued from previous page...

FRIDAY

Start	<input type="text" value="23:00"/>	End	<input type="text" value="00:00"/>
Start	<input type="text" value="00:00"/>	End	<input type="text" value="04:00"/>

SATURDAY

Start	<input type="text" value="23:00"/>	End	<input type="text" value="00:00"/>
Start	<input type="text" value="00:00"/>	End	<input type="text" value="04:00"/>

SUNDAY

Start	<input type="text" value="23:00"/>	End	<input type="text" value="00:00"/>
Start	<input type="text" value="00:00"/>	End	<input type="text" value="03:00"/>

Will the provision of late night refreshment take place indoors or outdoors or both?

- Indoors Outdoors Both

Where taking place in a building or other structure select as appropriate. Indoors may include a tent.

State type of activity to be authorised, if not already stated, and give relevant further details, for example (but not exclusively) whether or not music will be amplified or unamplified.

Restaurant to serve food from 10am until 1am Daily Dine in
From 1am - 3am Take out only daily. Sundays to Thursdays
From 1am - 4am Take out only daily. Fridays and Saturdays

State any seasonal variations.

For example (but not exclusively) where the activity will occur on additional days during the summer months.

None

Non standard timings. Where the premises will be used for the provision of late night refreshment at different times from those listed above, list below.

For example (but not exclusively), where you wish the activity to go on longer on a particular day e.g. Christmas Eve.

New Year premises license extension on 31/12 - 01/01 to trade until 5am.

Section 13 of 18

SUPPLY OF ALCOHOL

Will the schedule to supply alcohol be subject to change if this application to vary is successful?

- Yes No

Continued from previous page...

Section 14 of 18

ADULT ENTERTAINMENT

Highlight any adult entertainment or services, activities, or other entertainment or matters ancillary to the use of the premises that may give rise to concern in respect of children.

Provide information about anything intended to occur at the premises or ancillary to the use of the premises which may give rise to concern in respect of children, regardless of whether you intend children to have access to the premises, for example (but not exclusively) nudity or semi-nudity, films for restricted age groups etc gambling machines etc.

None

Section 15 of 18

HOURS PREMISES ARE OPEN TO THE PUBLIC

Standard Days And Timings

MONDAY

Start

End

Start

End

Provide timings in 24 hour clock (e.g., 16:00) and only give details for the days of the week when you intend the premises to be used for the activity.

TUESDAY

Start

End

Start

End

WEDNESDAY

Start

End

Start

End

THURSDAY

Start

End

Start

End

FRIDAY

Start

End

Start

End

SATURDAY

Start

End

Start

End

SUNDAY

Start

End

Start

End

State any seasonal variations.

Continued from previous page...

For example (but not exclusively) where the activity will occur on additional days during the summer months.

No seasonal variances

Non standard timings. Where you intend to use the premises to be open to the members and guests at different times from those listed above, list below.

For example (but not exclusively), where you wish the activity to go on longer on a particular day e.g. Christmas Eve.

New Year - 31/12 - 01/01 to trade until 5am - Takeout only after 1am

Continued from previous page...

Identify those conditions currently imposed on the licence which you believe could be removed as a consequence of the proposed variation you are seeking.

4. All members of staff shall be easily identifiable as such. If required by the Council in writing the licensee shall ensure that during the hours the licensed night café is open for business, every employee or person working for in the licensed premises wears a badge of a type approved by the Council indicating their name and that they are an employee or person working in the premises. (We believe this is not only intrusive but unfair given the nature of the business)

5. A notice showing the name of the person in charge of the premises at the time they are open under the licence shall be conspicuously exhibited in a position where it can be easily seen by customers. (We believe this is not only intrusive but unfair given the nature of the business)

7. The licence holder shall, if required by the Council, ensure that adequate sanitary accommodation is available in the premises for the free use of both staff and members of the public and in particular shall:

(i) maintain each sanitary convenience in clean and efficient order;

(ii) ensure that any room which contains a sanitary convenience is suitably and sufficiently lighted and ventilated and is kept clean;

(iii) ensure that in the sanitary accommodation provided there are installed and maintained suitable and sufficient wash-hand basins and that each basin is provided with an adequate supply of hot and cold water or of hot water at a suitably controlled temperature. - (We request that this condition is reviewed if not removed. This is due to the premises not holding more than 12 customers dining instore at any one time. Facilities are provided to the staff but this shouldn't be part of a licensing objective.)

8. When providing toilet facilities consideration shall be given to the needs of the disabled. Every effort shall be made to provide facilities capable of being used by disabled persons. - As point 7

9. The following fire-fighting appliances shall be efficiently maintained and be always immediately available for use:

(i) One fire blanket in a suitable container to be fixed to the wall adjacent to the cooking equipment in the ground floor cooking area.

(ii) One 2 Kg CO2 fire extinguisher shall be hung on a suitable bracket adjacent to the cooking equipment in the ground floor cooking area.

(iii) One 9 litre water type fire extinguisher shall be provided in the ground floor public area.

(iv) One 2kg CO2 fire extinguisher shall be hung on a suitable wall bracket in the basement office adjacent to the door leading into the room leading to the basement room containing the electrical intake and distribution board to the premises.

(v) One 9 litre water type fire extinguisher shall be hung on a suitable wall bracket in the basement office adjacent to the staircase leading to the ground floor. - (Again we believe this is not part of the licensing objective and instead a condition set by LBF).

Point 11/12/13/14/15/16/17 all fall under the authority and consideration of LBF

Point 18 /19 we believe is more of common sense and does not provide any responsibility to be charged to the employee to fight is safe to do so.

Point 22 - We believe is not necessary for the premises as there are no windows to the rear of the property and only fitted to the front main shop front.

Point 25 -The general lighting shall be maintained alight and the lighting to 'EXIT' or 'WAY OUT' notices shall not in any circumstances be extinguished or dimmed while the public are on the premises, provided that so long as there is sufficient daylight in any part of the premises, artificial light need not be used in that part. - We believe this is no longer required and that sufficient safety signs are acceptable under most authorities. Most of which is outdated and requires unnecessary level of control by the council.

Point 26/27 are typically not something that are covered in usual inspections. The owner welcomes such support but this isnt something that is typically listed in a license under the objectives.

Point 29 - we believe this is not only outdated but there is no clear instruction as to who to contact should approval be required in writing.

Point 30/31/32 - As point 25

Point 33/34 are not applicable to this type of business - batteries are not used

Point 39 - We believe this is relevant but not enforcable due to there being more noise emitted from the road outside than from the premises.

Point 41 - this would require council planning approval to change in such event, therefore anything would be already approved in such way.

Continued from previous page...

- I have enclosed the premises licence
- I have enclosed the relevant part of the premises licence

Reasons why I have failed to enclose the premises licence or relevant part of premises licence.

Section 16 of 18

LICENSING OBJECTIVES

Describe the steps you intend to take to promote the four licensing objectives:

a) General – all four licensing objectives (b,c,d,e)

List here steps you will take to promote all four licensing objectives together.

b) The prevention of crime and disorder

- CCTV is installed at the front, the kitchen and the rear of the property, recordings are kept for 30 days as standard and will be made available to any official who requires a copy providing they put this in writing.
- Crime prevention notices used in the shop making people aware they are on cctv and it is recorded. CCTV can also be accessed remotely via phone or computer.
- There is also a fully working and remote monitored alarm system with panic alarm button too.

c) Public safety

- There is a fire exit door at the back of the shop and a main entrance door.
- 2 managers are also fully first aid trained.
- There is also emergency lighting and exits lit if required.
 - The manager and supervisor are trained to deal with fire. The manager is also first aid trained and competent.
 - Fire Fighting equipment is on hand in the shop to deal with different types of fire, kitchen and customer areas.

d) The prevention of public nuisance

We will ensure vehicles are requested to turn engines off at night, to keep their lights off outside the shop and to ensure they are respectful when it comes to noise. We will patrol the area for litter and ensure the local immediate area is a clean and welcoming place. External signage can be switched off if required depending on the feedback.

e) The protection of children from harm

Children will only be allowed into the shop up to 11pm. Then anyone who looks young will be challenged and told to take out only. The aim of this is to ensure safety in store is taken care of and so that nothing is damaged in store. But the

Continued from previous page...

franchisee and franchisor will be clear that if any minor requires to take shelter in the premises for safety then they should be granted access and the emergency services contacted.

Section 17 of 18

NOTES ON REGULATED ENTERTAINMENT

In terms of specific **regulated entertainments** please note that:

- Plays: no licence is required for performances between 08:00 and 23.00 on any day, provided that the audience does not exceed 500.
- Films: no licence is required for 'not-for-profit' film exhibition held in community premises between 08.00 and 23.00 on any day provided that the audience does not exceed 500 and the organiser (a) gets consent to the screening from a person who is responsible for the premises; and (b) ensures that each such screening abides by age classification ratings.
- Indoor sporting events: no licence is required for performances between 08.00 and 23.00 on any day, provided that the audience does not exceed 1000.
- Boxing or Wrestling Entertainment: no licence is required for a contest, exhibition or display of Greco-Roman wrestling, or freestyle wrestling between 08.00 and 23.00 on any day, provided that the audience does not exceed 1000. Combined fighting sports – defined as a contest, exhibition or display which combines boxing or wrestling with one or more martial arts – are licensable as a boxing or wrestling entertainment rather than an indoor sporting event.
- Live music: no licence permission is required for:
 - o a performance of unamplified live music between 08.00 and 23.00 on any day, on any premises.
 - o a performance of amplified live music between 08.00 and 23.00 on any day on premises authorised to sell alcohol for consumption on those premises, provided that the audience does not exceed 500.
 - o a performance of amplified live music between 08.00 and 23.00 on any day, in a workplace that is not licensed to sell alcohol on those premises, provided that the audience does not exceed 500.
 - o a performance of amplified live music between 08.00 and 23.00 on any day, in a church hall, village hall, community hall, or other similar community premises, that is not licensed by a premises licence to sell alcohol, provided that (a) the audience does not exceed 500, and (b) the organiser gets consent for the performance from a person who is responsible for the premises.
 - o a performance of amplified live music between 08.00 and 23.00 on any day, at the non-residential premises of (i) a local authority, or (ii) a school, or (iii) a hospital, provided that (a) the audience does not exceed 500, and (b) the organiser gets consent for the performance on the relevant premises from: (i) the local authority concerned, or (ii) the school or (iii) the health care provider for the hospital.
- Recorded Music: no licence permission is required for:
 - o any playing of recorded music between 08.00 and 23.00 on any day on premises authorised to sell alcohol for consumption on those premises, provided that the audience does not exceed 500.
 - o any playing of recorded music between 08.00 and 23.00 on any day, in a church hall, village hall, community hall, or other similar community premises, that is not licensed by a premises licence to sell alcohol, provided that (a) the audience does not exceed 500, and (b) the organiser gets consent for the performance from a person who is responsible for the premises.
 - o any playing of recorded music between 08.00 and 23.00 on any day, at the non-residential premises of (i) a local authority, or (ii) a school, or (iii) a hospital, provided that (a) the audience does not exceed 500, and (b) the organiser gets consent for the performance on the relevant premises from: (i) the local authority concerned, or (ii) the school proprietor or (iii) the health care provider for the hospital.

Continued from previous page...

- Dance: no licence is required for performances between 08.00 and 23.00 on any day, provided that the audience does not exceed 500. However, a performance which amounts to adult entertainment remains licensable.
- Cross activity exemptions: no licence is required between 08.00 and 23.00 on any day, with no limit on audience size for:
 - o any entertainment taking place on the premises of the local authority where the entertainment is provided by or on behalf of the local authority;
 - o any entertainment taking place on the hospital premises of the health care provider where the entertainment is provided by or on behalf of the health care provider;
 - o any entertainment taking place on the premises of the school where the entertainment is provided by or on behalf of the school proprietor; and
 - o any entertainment (excluding films and a boxing or wrestling entertainment) taking place at a travelling circus, provided that (a) it takes place within a moveable structure that accommodates the audience, and (b) that the travelling circus has not been located on the same site for more than 28 consecutive days.

Section 18 of 18

PAYMENT DETAILS

This fee must be paid to the authority. If you complete the application online, you must pay it by debit or credit card.

Variation Fees are determined by the non-domestic rateable value of the premises.

To find out a premises non domestic rateable value go to the Valuation Office Agency site at http://www.voa.gov.uk/business_rates/index.htm

Band A - No RV to £4300 £100.00

Band B - £4301 to £33000 £190.00

Band C - £33001 to £8700 £315.00

Band D - £87001 to £12500 £450.00*

Band E - £125001 and over £635.00*

*If the premises rateable value is in Bands D or E and the premises is primarily used for the consumption of alcohol on the premises then your are required to pay a higher fee

Band D - £87001 to £12500 £900.00

Band E - £125001 and over £1,905.00

If you own a large premise you are subject to additional fees based upon the number in attendance at any one time

Capacity 5000-9999 £1,000.00

Capacity 10000 -14999 £2,000.00

Capacity 15000-19999 £4,000.00

Capacity 20000-29999 £8,000.00

Capacity 30000-39000 £16,000.00

Capacity 40000-49999 £24,000.00

Capacity 50000-59999 £32,000.00

Capacity 60000-69999 £40,000.00

Capacity 70000-79999 £48,000.00

Capacity 80000-89999 £56,000.00

Capacity 90000 and over £64,000.00

* Fee amount (£)

190.00

DECLARATION

* It is an offence, under section 158 of the licensing act 2003, to make a false statement in or in connection with this application. Those who make a false statement may be liable on summary conviction to a fine of any amount.

Ticking this box indicates you have read and understood the above declaration

This section should be completed by the applicant, unless you answered "Yes" to the question "Are you an agent acting on behalf of the applicant?"

Continued from previous page...

* Full name	<input type="text" value="Tom Corcoran"/>
* Capacity	<input type="text" value="FRANCHISOR"/>
* Date	<input type="text" value="06"/> / <input type="text" value="07"/> / <input type="text" value="2023"/> dd mm yyyy

Once you're finished you need to do the following:

1. Save this form to your computer by clicking file/save as...
 2. Go back to <https://www.gov.uk/apply-for-a-licence/premises-licence/hammersmith-and-fulham/change-1> to upload this file and continue with your application.
- Don't forget to make sure you have all your supporting documentation to hand.

IT IS AN OFFENCE, UNDER SECTION 158 OF THE LICENSING ACT 2003, TO MAKE A FALSE STATEMENT IN OR IN CONNECTION WITH THIS APPLICATION. THOSE WHO MAKE A FALSE STATEMENT MAY BE LIABLE ON SUMMARY CONVICTION TO A FINE OF ANY AMOUNT.

OFFICE USE ONLY

Applicant reference number	<input type="text" value="TCOM"/>
Fee paid	<input type="text"/>
Payment provider reference	<input type="text"/>
ELMS Payment Reference	<input type="text"/>
Payment status	<input type="text"/>
Payment authorisation code	<input type="text"/>
Payment authorisation date	<input type="text"/>
Date and time submitted	<input type="text"/>
Approval deadline	<input type="text"/>
Error message	<input type="text"/>
Is Digitally signed	<input type="checkbox"/>

[1](#) [2](#) [3](#) [4](#) [5](#) [6](#) [7](#) [8](#) [9](#) [10](#) [11](#) [12](#) [13](#) [14](#) [15](#) [16](#) [17](#) [18](#) [Next >](#)

2023/01489/LAPR - Chicken Cottage Variation Proposed Conditions to Remove

2. A clear copy of the licence shall be conspicuously displayed at all times within the premises and shall be adequately protected against theft, vandalism and defacement.
4. All members of staff shall be easily identifiable as such. If required by the Council in writing the licensee shall ensure that during the hours the licensed night café is open for business, every employee or person working for in the licensed premises wears a badge of a type approved by the Council indicating their name and that they are an employee or person working in the premises.
5. A notice showing the name of the person in charge of the premises at the time they are open under the licence shall be conspicuously exhibited in a position where it can be easily seen by customers.
7. The licence holder shall, if required by the Council, ensure that adequate sanitary accommodation is available in the premises for the free use of both staff and members of the public and in particular shall:
 - (i) maintain each sanitary convenience in clean and efficient order;
 - (ii) ensure that any room which contains a sanitary convenience is suitably and sufficiently lighted and ventilated and is kept clean;
 - (iii) ensure that in the sanitary accommodation provided there are installed and maintained suitable and sufficient wash-hand basins and that each basin is provided with an adequate supply of hot and cold water or of hot water at a suitably controlled temperature.
8. When providing toilet facilities consideration shall be given to the needs of the disabled. Every effort shall be made to provide facilities capable of being used by disabled persons.
9. The following fire-fighting appliances shall be efficiently maintained and be always immediately available for use:
 - (i) One fire blanket in a suitable container to be fixed to the wall adjacent to the cooking equipment in the ground floor cooking area.
 - (ii) One 2 Kg CO₂ fire extinguisher shall be hung on a suitable bracket adjacent to the cooking equipment in the ground floor cooking area.
 - (iii) One 9 litre water type fire extinguisher shall be provided in the ground floor public area.
 - (iv) One 2kg CO₂ fire extinguisher shall be hung on a suitable wall bracket in the basement office adjacent to the door leading into the room leading to the basement room containing the electrical intake and distribution board to the premises.
 - (v) One 9 litre water type fire extinguisher shall be hung on a suitable wall bracket in the basement office adjacent to the staircase leading to the ground floor.
10. The emergency means of escape on the ground floor to the rear of the premises must be maintained unobstructed at all times while the premises is used under the licence.
11. The emergency exit door on the ground floor to the rear of the premises shall be kept unlocked at all times while the premises is used under the licence.
12. All fire-resisting and smoke stop doors shall be maintained self-closing and shall not be secured open.
13. All exit doors shall be available for egress during the whole time that the public are on the premises by means of any fastenings other than panic bolts.
14. Locking bars, hasps, staples, screw eyes and other fastenings not approved by the Council shall not be fitted on exit doors.

15. Portable fire appliances shall be examined at least once a year and periodically tested in accordance with the current British Standard by a competent person and the date of such test shall be clearly marked on the appropriate extinguishers or on stout tabs securely attached to them. Extinguishers which incorporate an antifreeze agent shall be examined and recharged in compliance with manufacturer's instruction.

16. Where an automatic/manual fire alarm system has been installed and approved by the Council it shall be efficiently maintained in satisfactory working order. The system shall be maintained and serviced in accordance with Section 6 of the current BS 5839 Part 1 and tested regularly in accordance with conditions imposed by the Council. All checks, tests and defects shall be recorded in a log book.

17. All testing of fire appliances equipment and alarms shall be at the expense of the licensee.

18. The Fire Brigade shall be called to any outbreak of fire, however slight.

19. Suitable notices shall be displayed indicating how the Brigade can be summoned.

20. The licensee shall ensure that the public are not admitted to any part or parts of the premises other than those which have been approved by the Council.

21. The means of escape provided for all persons on the premises shall be maintained unobstructed, immediately available and clearly identifiable in accordance with the approved arrangements to the satisfaction of the Council.

22. Except with the consent of the Council, bars, wire guards or the like shall not be fitted to windows, nor shall the windows be otherwise obstructed in a manner likely to render them unavailable for the purposes of exit in case of emergency.

23. Advertisement boards or easels shall not be placed in positions in which they are likely to obstruct means of egress or to be overturned.

24. The owner, occupier or any other person concerned in the conduct or management of the premises shall, in the absence of adequate daylight, ensure that adequate lighting is maintained to the satisfaction of the Council in all parts of the premises to which the public and staff have access and is in operation continuously during the whole time the premises are open to the public.

25. The general lighting shall be maintained alight and the lighting to 'EXIT' or 'WAY OUT' notices shall not in any circumstances be extinguished or dimmed while the public are on the premises, provided that so long as there is sufficient daylight in any part of the premises, artificial light need not be used in that part.

26. The electrical and gas installations for the premises shall be maintained in a safe working condition, as prescribed in the current edition of the Regulations.

27. Unless the Council decide otherwise, an Electrical Inspection Certificate, Certificates as prescribed in the current edition of the Regulations for Electrical Installations issued by the Institution of Electrical Engineers, for the electrical installation associated with the premises shall be submitted to the Council at least once every five years or such other time specified on the certificate. The certificate shall be signed by a qualified engineer.

28. Portable heating appliances shall not be used at the premises unless consent of the Council has been obtained.

29. Appliances utilising cylinders or containers of gas under pressure shall not be used on the premises except with the prior consent of the Council and in accordance with such conditions, as the Council may consider necessary.

NOTE: The use of liquid petroleum gas in cylinders is unlikely to be approved.

30. Two independent systems of lighting shall be provided to the satisfaction of the Council. The degree of illumination from each system shall be sufficient for illumination of the exit notices (if these are not of the self-luminous type) and to enable the public to see their way out of the premises at any time.

31. Where permitted by the Council a non-maintained system of escape lighting may be used (i.e. a system in which the lights are energised only when normal lighting fails).

32. The licensee may, with the consent of the Council, provide such additional lighting for decorative or other purposes as he may think fit.

33. In relation to any storage battery which may be accepted by the Council in connection with escape lighting:

- (i) It shall be fully charged before the first admission of the public on any day;
- (ii) The approved 'load' connected to the battery shall not be altered unless the consent of the Council is previously obtained;
- (iii) A diagram of the connections of the battery and the accepted circuits connected thereto shall be exhibited in the battery control room;

34. The battery shall be under the regular maintenance of a firm of battery manufacturers or, with the approval of the Council, other persons deemed competent, who shall arrange for a thorough examination at least once in every six months, when the battery shall be discharged by taking its full load for half its rated discharge period or for one hour (whichever is the less). In addition, any automatic switching devices shall be frequently tested.

35. In the event of the failure of the normal system of lighting

- (i) where the escape lighting has a 1 hour capacity the public shall be required to leave the building within a maximum period of 30 minutes and
- (ii) where the escape lighting has a 3 hour capacity the public shall be required to leave the building within a maximum period of 1 hour and shall not be re-admitted until the lighting from the system has been fully restored and the battery fully recharged.

36. Where required by the Council a diagram and/or schedule indicating clearly the arrangements of the circuits and sub circuits, the position of the distribution boards and the sizes of the cables shall be provided and kept in an accessible position on the premises.

41. All flues shall terminate in such a position as not to cause a nuisance.

Chicken Cottage, West Kensington, 82 North end road, London, W14 9ES

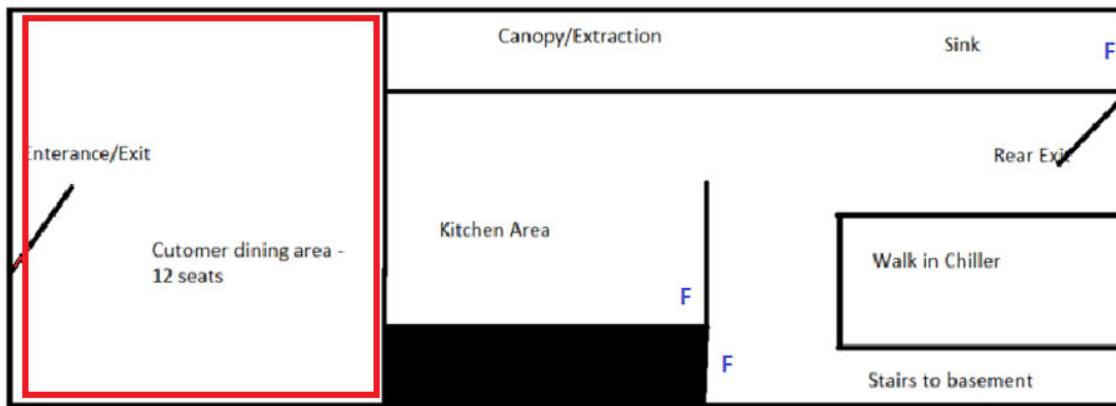

F = Fire Fighting Equipment

Chicken Cottage - 82 North End Road, Ground Floor

Basement

